

JIC STANDARD CONNECTIONS

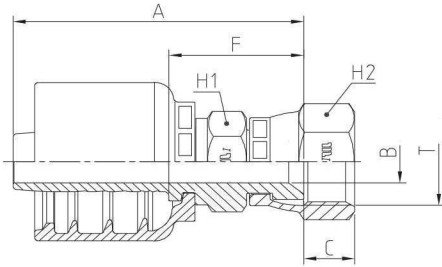

OPNS22711 OPNS22711KR

**JIC FEMALE 37° CONE SEAT DOUBLE HEXAGON
SAE J516/ISO 12151-5 (CRIMPED-BACK NUT)**
**JIC HEMBRA RECTA ASIENTO A 37° DOBLE HEXÁGONO SAE J516/
ISO 12151-5 (CRIMPADO DETRAS DE LA TUERCA)**

PART. REF.	HOSE BORE			THREAD	DIMENSIONS inch					
------------	-----------	--	--	--------	--------------------	--	--	--	--	--

	DN	inch	Size		B	A	C	F	H ₁	H ₂
OPNS22711-06-06KR	10	3/8"	- 06	9/16" - 18	0.28	2.03	0.37	0.87	0.67	0.67
OPNS22711-06-08KR	10	3/8"	- 06	3/4" - 16	0.37	2.20	0.42	0.85	0.75	0.87
OPNS22711-08-08KR	12	1/2"	- 08	3/4" - 16	0.37	2.28	0.42	1.06	0.75	0.87
OPNS22711-08-10KR	12	1/2"	- 08	7/8" - 14	0.37	2.39	0.49	1.17	0.87	0.98
OPNS22711-12-12KR	19	3/4"	- 12	1.1/16" - 12	0.59	2.62	0.56	1.19	1.06	1.25
OPNS22711-16-16	25	1"	- 16	1.5/16" - 12	0.78	3.29	0.60	1.40	1.26	1.50
OPNS22711-20-20	31	1.1/4"	- 20	1.5/8" - 12	1.02	3.72	0.63	1.65	1.61	1.97
OPNS22711-24-24	38	1.1/2"	- 24	1.7/8" - 12	1.26	4.28	0.73	1.83	1.97	2.36
VOPNS22711-32-32	51	2"	- 32"	2.1/2" - 12	1.65	4.60	0.93	1.99	2.56	2.95

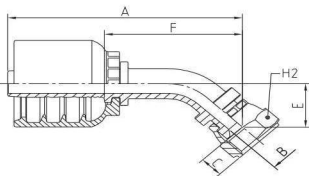

OPNS22541KR

**45° ELBOW JIC FEMALE 37° CONE SEAT - SAE J516/ISO 12151-5
(CRIMPED-BACK NUT)**
**JIC HEMBRA CODO 45° ASIENTO A 37° - SAE J516/ISO 12151-5
(CRIMPADO DETRAS DE LA TUERCA)**

PART. REF.	HOSE BORE			THREAD	DIMENSIONS inch					
------------	-----------	--	--	--------	--------------------	--	--	--	--	--

	DN	inch	Size		B	A	C	E	F	H ₂
OPNS22541-06-06KR	10	3/8"	- 06	9/16" - 18	0.28	2.81	0.37	0.63	1.65	0.67
OPNS22541-08-08KR	12	1/2"	- 08	3/4" - 16	0.37	3.28	0.42	0.79	2.05	0.87
OPNS22541-10-10KR	16	5/8"	- 10	7/8" - 14	0.49	3.79	0.49	0.89	2.44	0.98
OPNS22541-12-12KR	19	3/4"	- 12	1.1/16" - 12	0.59	4.20	0.56	1.08	2.76	1.26