

OPNS TYPE



SUPERCAT FLANGE STANDARD CONNECTIONS

OPNS23911

STRAIGHT SUPERCAT FLANGE

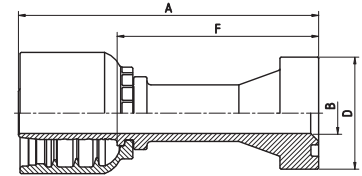

PART. REF.	HOSE BORE			FLANGE	DIMENSIONS inch					
	DN	inch	Size		B	A	D	F	S	
OPNS23911-12-12	19	3/4"	- 12	3/4"	0.59	4.37	1.63	2.93	0.56	
OPNS23911-16-16	25	1"	- 16	1"	0.78	5.31	1.88	3.42	0.56	
OPNS23911-16-20	25	1"	- 16	1.1/4"	1.02	5.53	2.13	3.63	0.56	
OPNS23911-20-20	31	1.1/4"	- 20	1.1/4"	1.02	5.45	2.13	3.39	0.56	
OPNS23911-24-24	38	1.1/2"	- 24	1.1/2"	1.26	6.14	2.50	3.70	0.56	

OPNS23991

90° SUPERCAT FLANGE

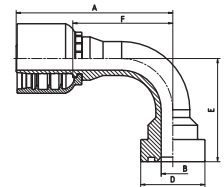

PART. REF.	HOSE BORE			FLANGE	DIMENSIONS inch					
	DN	inch	Size		B	A	D	E	F	S
OPNS23991-12-12	19	3/4"	- 12	3/4"	0.59	3.98	1.63	2.62	2.54	0.56
OPNS23991-16-16	25	1"	- 16	1"	0.78	4.95	1.88	3.01	3.05	0.56
OPNS23991-16-20	25	1"	- 16	1"	1.02	4.87	2.13	3.17	2.97	0.56
OPNS23991-20-20	31	1.1/4"	- 20	1.1/4"	1.02	5.43	2.13	3.43	3.37	0.56

OPNS23941

45° SUPERCAT FLANGE

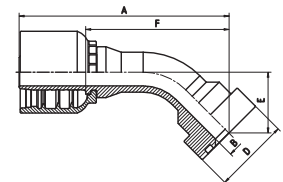

PART. REF.	HOSE BORE			FLANGE	DIMENSIONS inch					
	DN	inch	Size		B	A	D	E	F	S
OPNS23941-12-12	19	3/4"	- 12	3/4"	0.59	4.53	1.63	1.32	3.09	0.56
OPNS23941-16-16	25	1"	- 16	1"	0.78	5.42	1.88	1.44	3.53	0.56
OPNS23941-16-20	25	1"	- 16	1.1/4"	1.02	5.54	2.13	1.59	3.64	0.56
OPNS23941-20-20	31	1.1/4"	- 20	1.1/4"	1.02	5.96	2.13	1.63	3.90	0.56