



OPS TYPE



METRIC 24° O-RING STANDARD CONNECTIONS

OPS11210

METRIC MALE 24° CONE SEAT H.T. - DIN 20066/3861

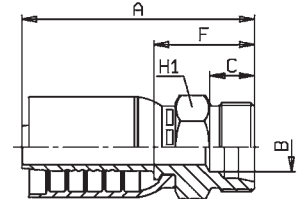

PART. REF.	HOSE BORE			THREAD	PIPE	DIMENSIONS inch				
	DN	inch	Size			B	A	C	F	H ₁
OPS11210-10-30	16	5/8"	- 10	M 30x2	20	0.59	2.76	0.63	1.41	1.18
OPS11210-12-36	19	3/4"	- 12	M 36x2	25	0.78	3.69	0.71	1.59	1.42
OPS11210-16-42	25	1"	- 16	M 42x2	30	0.98	4.02	0.79	1.69	1.81
OPS11210-20-52	31	1.1/4"	- 20	M 52x2	38	1.18	4.52	0.87	1.93	2.17

OPS21612

O-RING METRIC FEMALE 24° CONE H.T.
DIN 20066/3865 (THRUST-WIRE NUT)

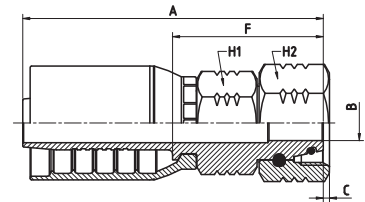

OPS21613

O-RING METRIC FEMALE 24° CONE H.T.
DIN 20066/3865 (SLIP-ON NUT)

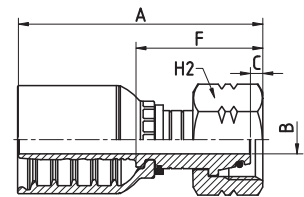

PART. REF.	HOSE BORE			THREAD	PIPE	DIMENSIONS inch					
	DN	inch	Size			B	A	C	F	H ₁	H ₂
OPS21613-10-30	16	5/8"	- 10	M 30x2	20	0.49	2.89	0.17	1.54	-	1.42
OPS21612-12-36	19	3/4"	- 12	M 36x2	25	0.55	3.85	0.23	1.58	1.42	1.81
OPS21612-16-42	25	1"	- 16	M 42x2	30	0.75	4.15	0.34	1.82	1.62	1.97
OPS21612-20-52	31	1.1/4"	- 20	M 52x2	38	0.97	4.53	0.38	1.93	1.97	2.36