

JIC STANDARD CONNECTIONS

OPS22711KR

JIC FEMALE 37° CONE SEAT DOUBLE HEXAGON - SAE J516/ISO 12151-5
(CRIMPED-BACK NUT)

JIC HEMBRA CODO ASIENTO A 37° DOBLE HEXÁGONO - SAE J516/ISO 12151-5
(CRIMPADO DETRAS DE LA TUERCA)

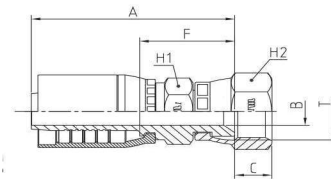

| PART. REF. | HOSE BORE | | | THREAD | DIMENSIONS inch | | | | | |
|-------------------|-----------|------|------|------------|--------------------|------|------|------|------|----------------|
| | DN | inch | Size | | B | A | C | E | F | H ₂ |
| OPNS22711-06-06KR | 10 | 3/8" | -06 | 9/16" - 18 | 0.28 | 2.03 | 0.37 | 0.87 | 0.67 | 0.67 |
| OPNS22711-08-08KR | 12 | 1/2" | -08 | 3/4" - 16 | 0.37 | 2.28 | 0.42 | 1.06 | 0.75 | 0.87 |

OPS22591KR

90° ELBOW JIC FEMALE 37° CONE SEAT SAE J516/ISO 12151-5
(CRIMPED-BACK NUT)

JIC HEMBRA CODO 90° ASIENTO A 37° - SAE J516/ISO 12151-5
(CRIMPADO DETRAS DE LA TUERCA)

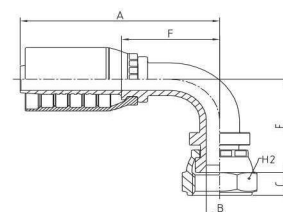

| PART. REF. | HOSE BORE | | | THREAD | DIMENSIONS inch | | | | | |
|------------------|-----------|------|------|------------|--------------------|------|------|------|------|----------------|
| | DN | inch | Size | | B | A | C | E | F | H ₂ |
| OPS22591-06-06KR | 10 | 3/8" | -06 | 9/16" - 18 | 0.28 | 2.56 | 0.37 | 1.26 | 1.40 | 0.67 |
| OPS22591-08-08KR | 12 | 1/2" | -08 | 3/4" - 16 | 0.37 | 2.96 | 0.42 | 1.61 | 1.73 | 0.87 |
| OPS22591-10-10KR | 16 | 5/8" | -10 | 7/8" - 14 | 0.49 | 3.46 | 0.49 | 1.85 | 2.11 | 0.98 |