



OPS TYPE

JIC STANDARD CONNECTIONS

OPS22712

JIC FEMALE 37° CONE SEAT - SAE J516/J514 (THRUST-WIRE NUT)

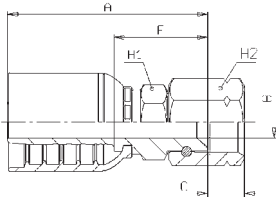

PART. REF.	HOSE BORE			THREAD	DIMENSIONS inch					
	DN	inch	Size		B	A	C	F	H ₁	H ₂
OPS22712-06-06	10	3/8"	- 06	9/16" - 18	0.28	2.11	0.36	0.97	0.67	0.75
OPS22712-06-08	10	3/8"	- 06	3/4" - 16	0.37	2.20	0.40	1.07	0.75	0.87
OPS22712-08-08	12	1/2"	- 08	3/4" - 16	0.37	2.28	0.40	1.08	0.75	0.87
OPS22712-08-10	12	1/2"	- 08	7/8" - 14	0.49	2.32	0.48	1.12	0.87	1.06
OPS22712-10-10	16	5/8"	- 10	7/8" - 14	0.49	2.44	0.48	1.11	0.87	1.06
OPS22712-10-12	16	5/8"	- 10	1.1/16" - 12	0.59	2.53	0.56	1.18	1.06	1.25
OPS22712-12-12	19	3/4"	- 12	1.1/16" - 12	0.55	3.35	0.56	1.26	1.06	1.25
OPS22712-12-14	19	3/4"	- 14	1.3/16" - 12	0.55	3.38	0.54	1.28	1.25	1.42
OPS22712-12-16	19	3/4"	- 12	1.5/16" - 12	0.75	3.43	0.6	1.34	1.25	1.62
OPS22712-16-16	25	1"	- 16	1.5/16" - 12	0.75	3.68	0.6	1.35	1.25	1.62
OPS22712-16-20	25	1"	- 16	1.5/8" - 12	1.02	4.07	0.64	1.74	1.62	1.97
OPS22712-20-16	31	1.1/4"	- 20	1.5/16" - 12	0.75	4.19	0.6	1.59	1.81	1.62
OPS22712-20-20	31	1.1/4"	- 20	1.5/8" - 12	0.97	4.35	0.64	1.75	1.62	1.97
OPS22712-20-24	31	1.1/4"	- 20	1.7/8" - 12	1.26	4.51	0.73	1.91	1.97	2.36
OPS22712-24-24	38	1.1/2"	- 24	1.7/8" - 12	1.19	4.65	0.73	1.98	1.97	2.36
OPS22712-32-32	51	2"	- 32	2.1/2" - 12	1.53	5.87	0.93	2.13	2.56	2.95